

Sangfor NGAF

SMTP Server Configuration Guide

Product Version	8.0.35
Document Version	01
Released on	Jul. 05, 2021



Copyright © Sangfor Technologies Inc. 2021. All rights reserved.

Unless otherwise stated or authorized, Sangfor Technologies Inc. (hereinafter referred to as "Sangfor") and its affiliates reserve all intellectual property rights, including but not limited to copyrights, trademarks, patents, and trade secrets, and related rights to text, images, pictures, photographs, audio, videos, charts, colors, and layouts as presented in or concerning this document and content therein. Without prior written consent of Sangfor, this document and content therein must not be reproduced, forwarded, adapted, modified or displayed or distributed by any other means for any purpose.

Disclaimer

Products, services or features described in this document, whether wholly or in part, may be not within your purchase scope or usage scope. The products, services or features you purchase must be subject to the commercial contract and terms as agreed by you and Sangfor. Unless otherwise provided in the contract, Sangfor disclaims warranties of any kind, either express or implied, for the content of this document.

Due to product version upgrades or other reasons, the content of this document will be updated from time to time. Unless otherwise agreed, this document is used for reference only, and all statements, information, and recommendations therein do not constitute any express or implied warranties.

Change Log

Date	Change Description
Jul. 05, 2021	This is the first release of this document.

Contents

Change Log.....	1
1 Introduction	3
1.1 Abbreviations and conventions.....	3
1.2 Feedback.....	3
2 Abbreviations and Conventions.....	4
3 Background	4
4 Configuration	4
5 Testing Result.....	6

1 Introduction

1.1 Abbreviations and conventions

NGAF in this article refers to the SANGFOR NGAF device.

1.2 Feedback

If you find any questions of this documents, please feel free to give us feedback, email:
tech.support@sangfor.com.

2 Abbreviations and Conventions

SMTP: A relatively simple text-based standard protocol for transmitting e-mail on the internet.

Listening Port: TCP port 25

SSL Enabled Listening Port: 465

3 Background

Scenario: You can set up an SMTP server to enable alerts for firewall management and endpoint events. When an alert is triggered firewall sends an email notification to the configured email address.

4 Configuration

Step 1. Go to the **System** page

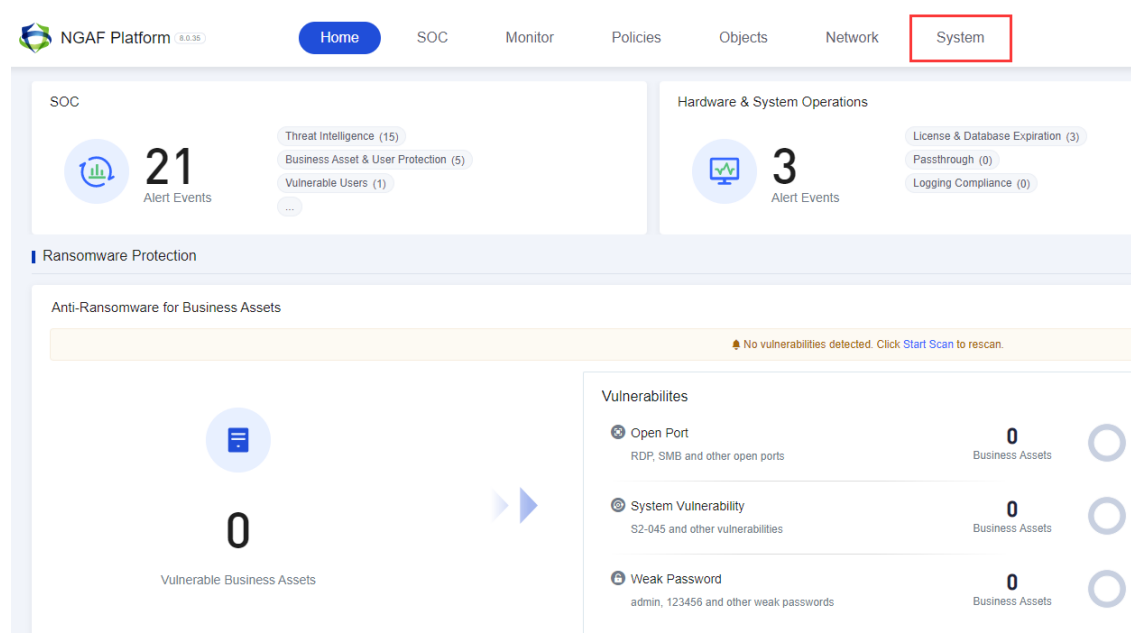

Step 2. In **General Settings**, select the SMTP Server

NGAF Platform 8.0.35

Home SOC Monitor Policies Objects Network **System**

System

General Settings

Security Capability Update

Troubleshooting

SNMP

Administrator

Maintenance

High Availability

Central Management

Web UI Network **SMTP Server** System Time Hosts Licensing Privacy Options

Central Management | The page can be configured.

☒ Specified email server ⓘ

Sender Email Address:

SMTP Server:

Server Port:

Decryption: ☐ SSL

☐ Authentication Required

Username: ⓘ

Password:

☐ Built-in email server ⓘ

Step 3. Fill in the necessary information as figure shown below.

☒ Specified email server ⓘ

Sender Email Address: Input the sender email address

SMTP Server: Input the SMTP server domain name. (e.g., smtp.gmail.com)

Server Port: Input the port number

Decryption: ☒ SSL Optional: Check this option, if you wish to send the email over an encrypted channel.

☒ Authentication Required

Username: Input the administrator login email ⓘ

Password: Credential of the administrator email

☐ Built-in email server ⓘ

3 Finally save your configuration

Decryption SSL: Once checked, listening port number will be changed from port 25 to port 465.

NOTICE

Different SMTP Server may have different mail server names and port. Current NGAF does not support the smtp service configured with STARTLS.

Example:

Organization	SMTP Server Name	SMTP Port
Gmail	smtp.gmail.com	465
Yahoo!	smtp.mail.yahoo.com	465

5 Testing Result

This section will verify the SMTP Server configuration.

Step 1. On the **SMTP Server** section, click **Send Test Email** right below the authentication field.

The screenshot shows the 'SMTP Server' configuration page. The 'Specified email server' section is active. The 'Sender Email Address' field contains a masked email address ending in '@gmail.com'. The 'SMTP Server' field contains 'smtp.gmail.com'. The 'Server Port' field contains '465'. The 'Decryption' section has 'SSL' selected. The 'Authentication Required' checkbox is checked. Below this, the 'Username' and 'Password' fields are present, with the password masked. The 'Send Test Email' button is highlighted with a red rectangular box. At the bottom, there is a 'Save' button and an option for 'Built-in email server' which is not selected.

Step 2. A recipient address box will prompt to ask for the recipient email address. Input the appropriate recipient email address, then click **Test**.

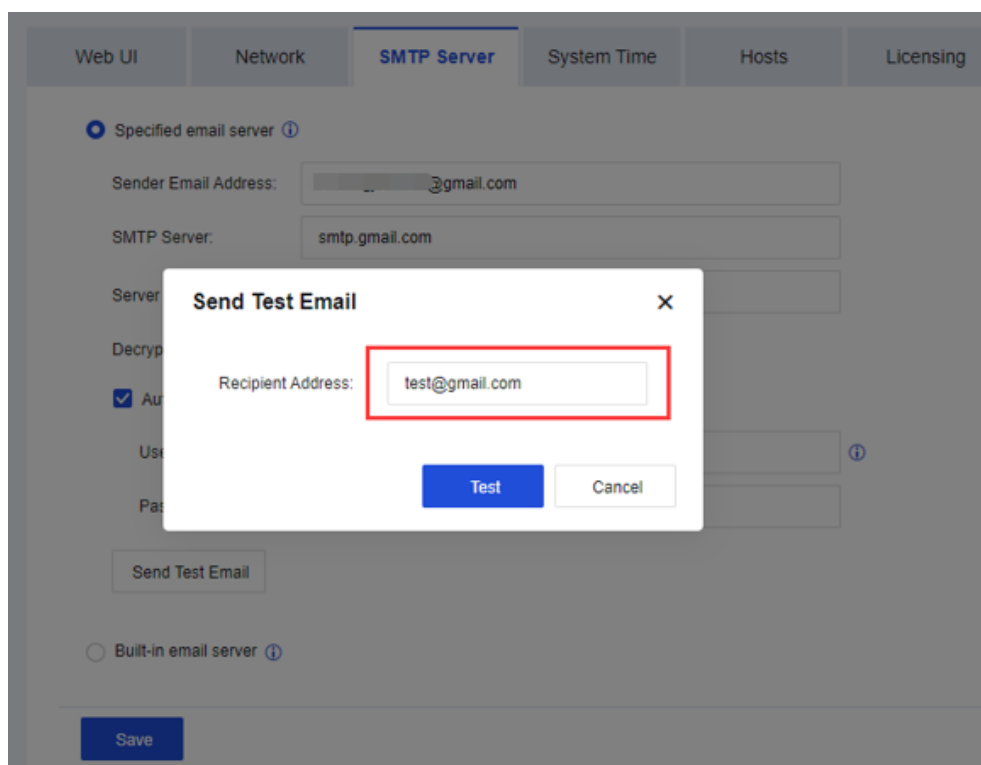

Step 3. A **Send Test Email Successfully** will prompts out at the topmost, if a test email has been sent successfully.

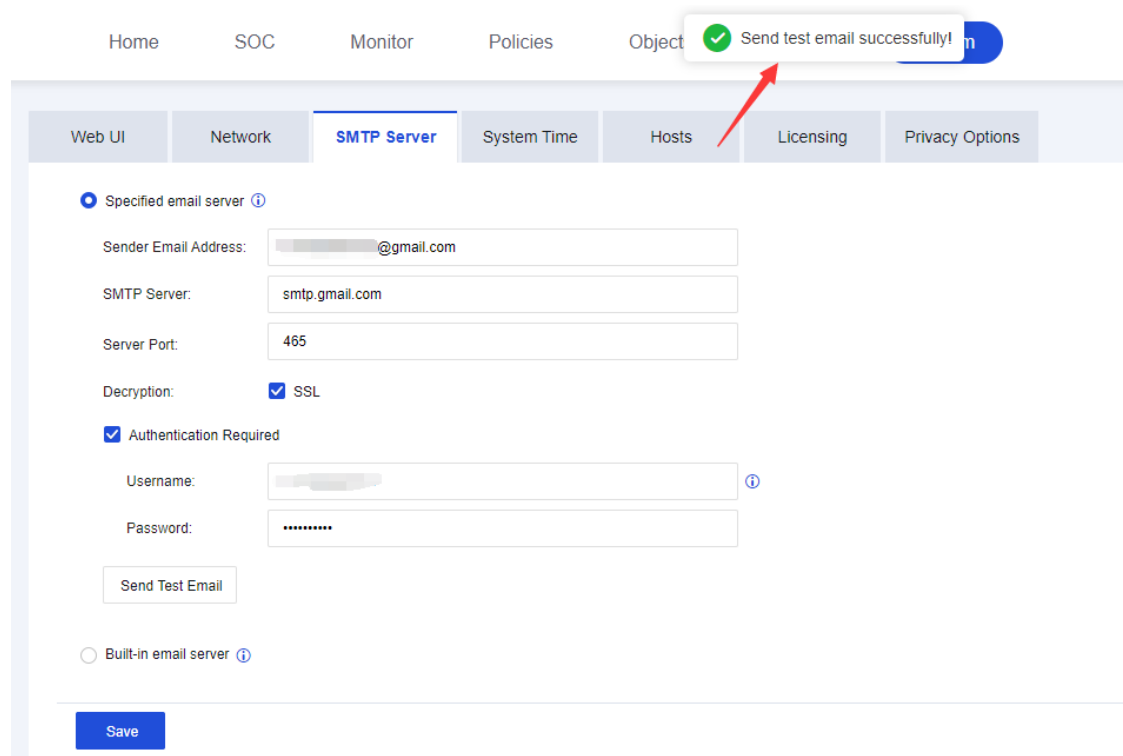

Step 4. You can verify the send test email logs by going to, **System > Troubleshooting > Logs**.

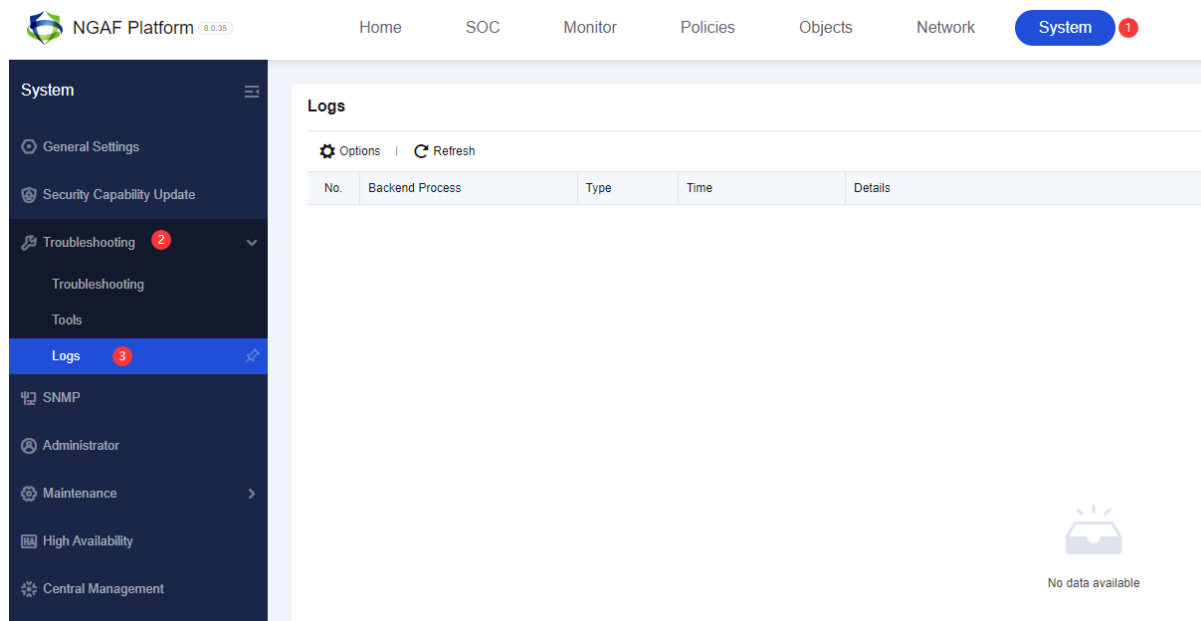

Step 5. Select **Options** then a **Settings** box will pop-out; check the **Info** and **Email Alarm**, click **Save**.

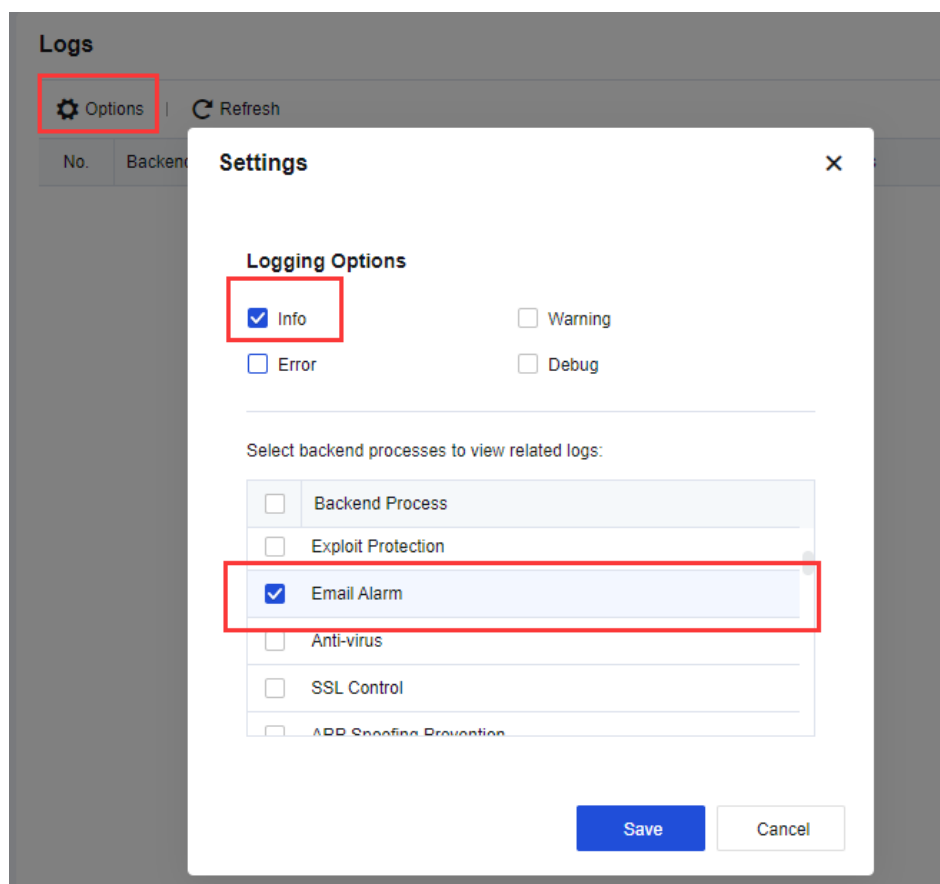

Step 6. You can see Email Alarm logs on the list and other details.

Logs

Options Refresh				
No.	Backend Process	Type	Time	Details
1	Email Alarm	Info	21:54:37	i1:mailsnd.cpp:1331 Send (Testing email) email successfully
2	Email Alarm	Info	21:54:27	i1:mailsnd.cpp:859 Add testing email
3	Email Alarm	Info	21:53:50	i1:mailsnd.cpp:1210 the notify of udp has no <mail_to>
4	Email Alarm	Info	21:53:49	i1:mailsnd.cpp:747 Add management email
5	Email Alarm	Info	19:53:38	i1:mailsnd.cpp:1210 the notify of udp has no <mail_to>
6	Email Alarm	Info	19:53:38	i1:mailsnd.cpp:747 Add management email

Step 7. Check the email inbox, if the recipient received the testing email means the SMTP Server has been successfully configured.

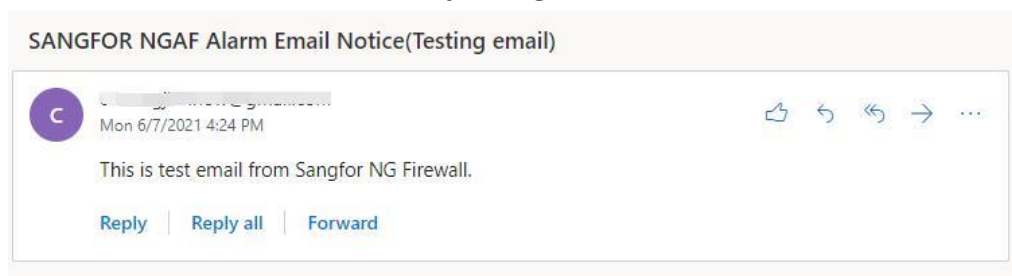



SANGFOR

