

## Partner One Password Retrieval Guideline

Step 1: Log in Partner One ( <https://one.sangfor.com/> )  
Select the appropriate login option based on your region.



Step 2: If you forgot or you can't find your password, you can click "retrieve password".

Step 3: Enter your email to receive a verification code.

Step 4: Reset the new password and use your new password login.

Step 5: Save the modification and log in to Partner One with the new password.

***Make Your Digital Transformation Simpler and Secure***

**Sangfor Technologies (Hong Kong) Limited**

Unit 1612-16, 16/F, The Metropolis Tower, 10 Metropolis Drive, Hung Hom, Kowloon, Hong Kong

E.: [elaine.xiang@sangfor.com](mailto:elaine.xiang@sangfor.com)

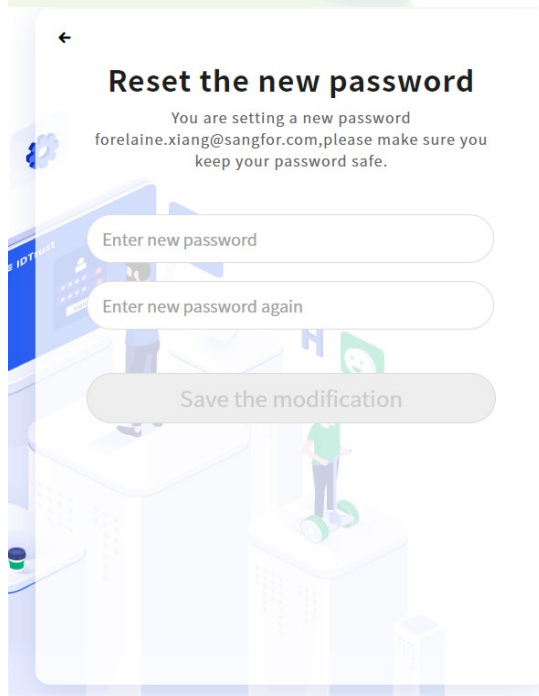
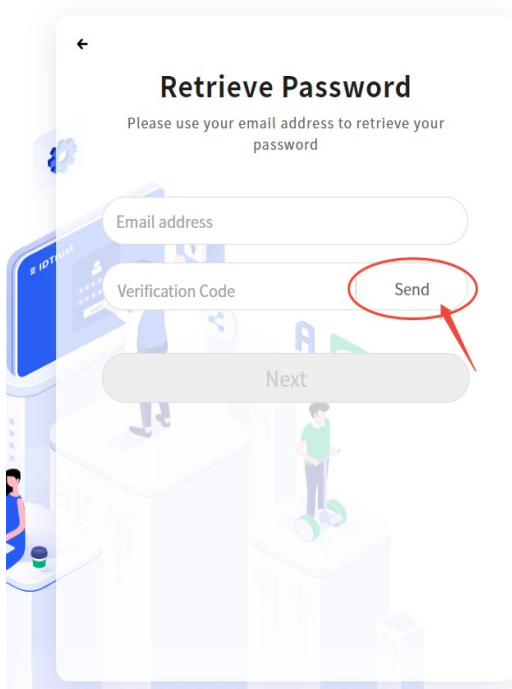
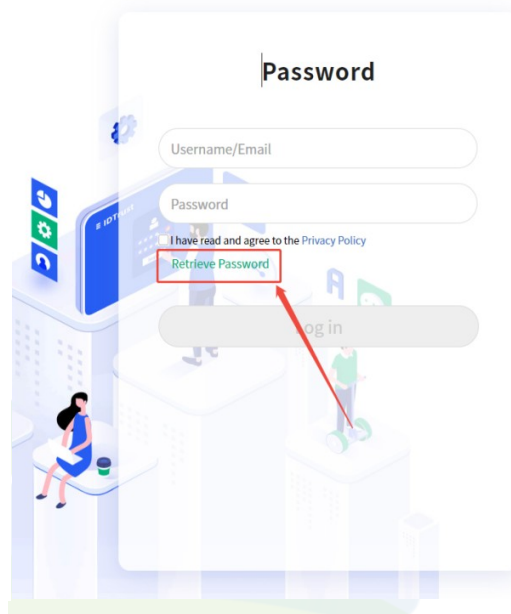
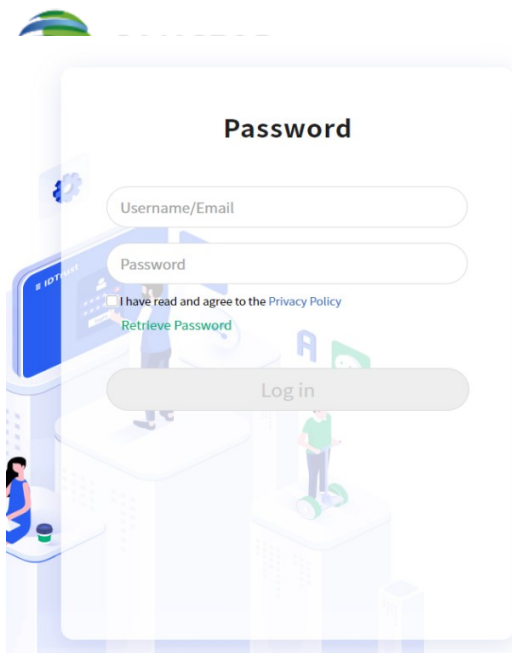

If you have any related questions, please feel free to contact [elaine.xiang@sangfor.com](mailto:elaine.xiang@sangfor.com).

***Make Your Digital Transformation Simpler and Secure***

**Sangfor Technologies (Hong Kong) Limited**

Unit 1612-16, 16/F, The Metropolis Tower, 10 Metropolis Drive, Hung Hom, Kowloon, Hong Kong

E.: [elaine.xiang@sangfor.com](mailto:elaine.xiang@sangfor.com)